

## MEETINGS & EVENTS

## PARCO DEI PRINCIPI GRAND HOTEL & SPA

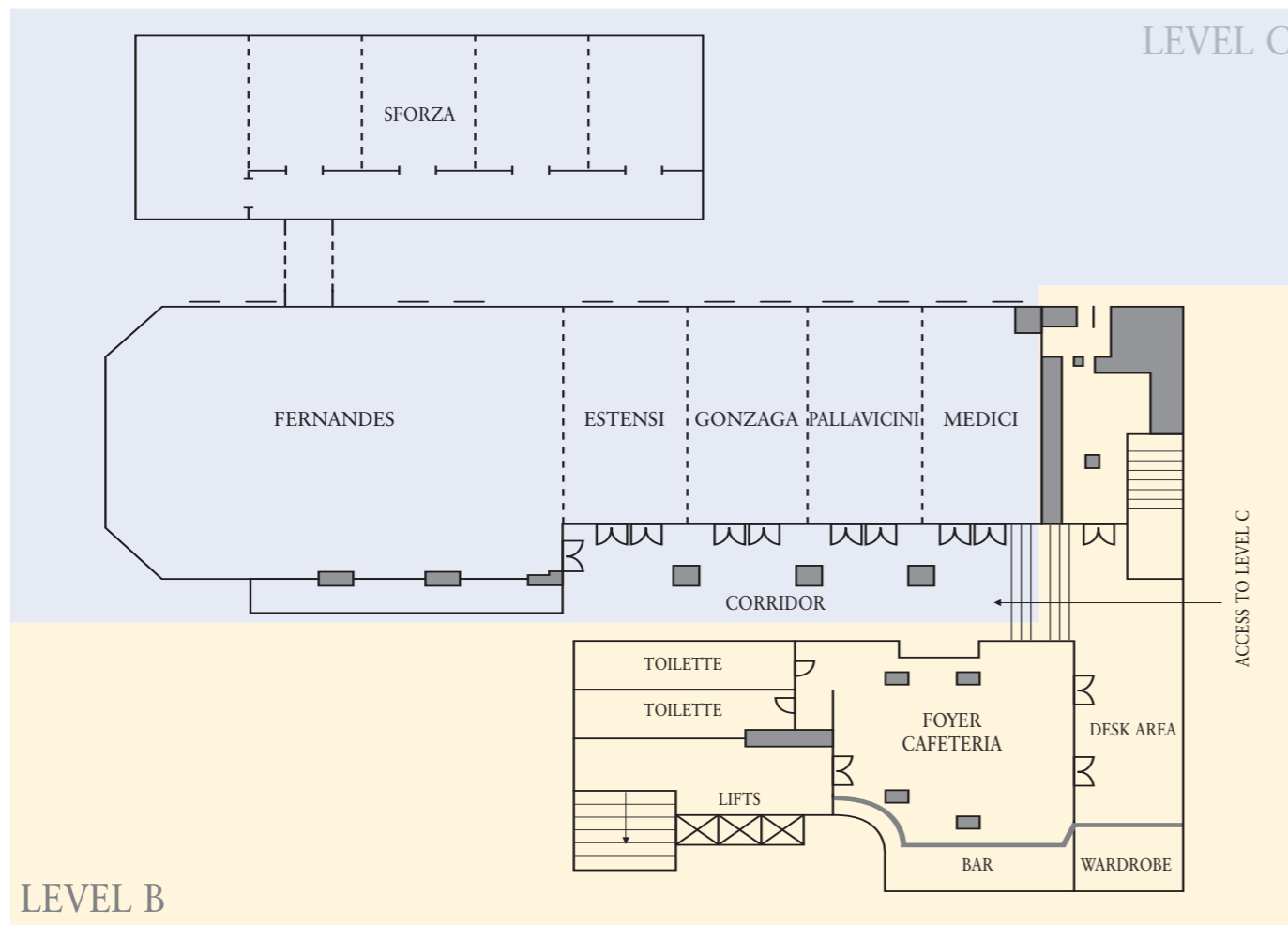

### LOCATION AND POINTS OF INTEREST

Rome "caput mundi". Facing Villa Borghese, surrounded by a magnificent private botanic park, unique for its extension. An island of tranquility in the best central tail: at five minutes from the Central Station, just a walking distance from the charming Via Veneto and the "downtown" great expositions, the Parco dei Principi Grand Hotel & SPA is the perfect meeting-point for the most touristic excursions of the "eternal city".

### GUEST ROOM INFORMATION

Numbers of floors: 7  
 Numbers of guest lift to floors: 3  
 Numbers of special elevator for luggage: 2  
 Parking facilities: 40/60+outdoor

### ROOMS CONFIGURATION

Double/Twin rooms: 139  
 Single rooms: 15  
 Junior suite: 10  
 Deluxe suite: 13  
 Presidential suite: 1  
 Royal suite (350 sq. meters): 1

### HOTEL FACILITIES AND SERVICES

Air-conditioning	Electric power: 220 V	Florist
Safe	Sound proof rooms	Business centre
Radio & Satellite TV	Panoramic terraces	Prince SPA
Mini Bar	Concierge	Fitness centre
Room service	Excursions - Guided tours	Garden
Laundry & dry cleaning	Baby sitting	Outdoor swimming pool

### CONFERENCE & MEETING FACILITIES

14 meeting Rooms - Banqueting & Conference space up to 900 persons.

### RESTAURANT AND BAR

Pauline Restaurant. Cuisine "à la carte" - The best recipes of the Italian Cuisine	lunch: 12,15/15,00 - dinner: 19,00/22,30
Bar La Pomme - Premium brands - Cocktails - Piano Bar	open from 9,30 to 01,00
Water Bar & Grill - Pool side	open from 10,00 to 18,00 (seasonal)
Lounge Bar - Cafeteria (Congress Area)	on request

LEVEL B

	Fernandes	Estensi	Gonzaga	Pallavicini	Medici	Sforza	Foyer Cafeteria
<b>Rooms Dimension</b>							
meters	28,80x14,60	7,20x13,40	7,20x13,40	7,20x13,40	8,90x13,40	35,00x12	•
feet	94,46x47,80	23,60x21,5	23,60x21,5	23,60x21,5	29x44,60	114,80x39,35	•
square m.	420	97,92	97,92	97,92	120	420	200
square ft.	4.519	1.053	1.053	1.053	1.291	4.520,84	2.160
door dimensions m.	1,14x2,45	2,28x2,45	2,28x2,45	2,28x2,45	2,28x2,45	•	2,50x2
door dimensions ft.	3,74x8,03	7,47x8,03	7,47x8,03	7,47x8,03	7,47x8,03	•	8x6,50
ceiling height m.	5,20	5,20	5,20	5,20	5,20	4,50	2,30
ceiling height ft.	17	17	17	17	17	14,76	8,85
<b>Capacity</b>							
theatre style	550	80	80	80	90	500	•
class room style	200	40	40	40	50	200	•
"U" shape style	100	30	30	30	35	100	•
cocktail party	500	60	60	60	80	500	•
dinner round tables	350	50	50	50	80	350	•
buffet available	300	50	50	50	60	300	•

## MEETINGS & EVENTS

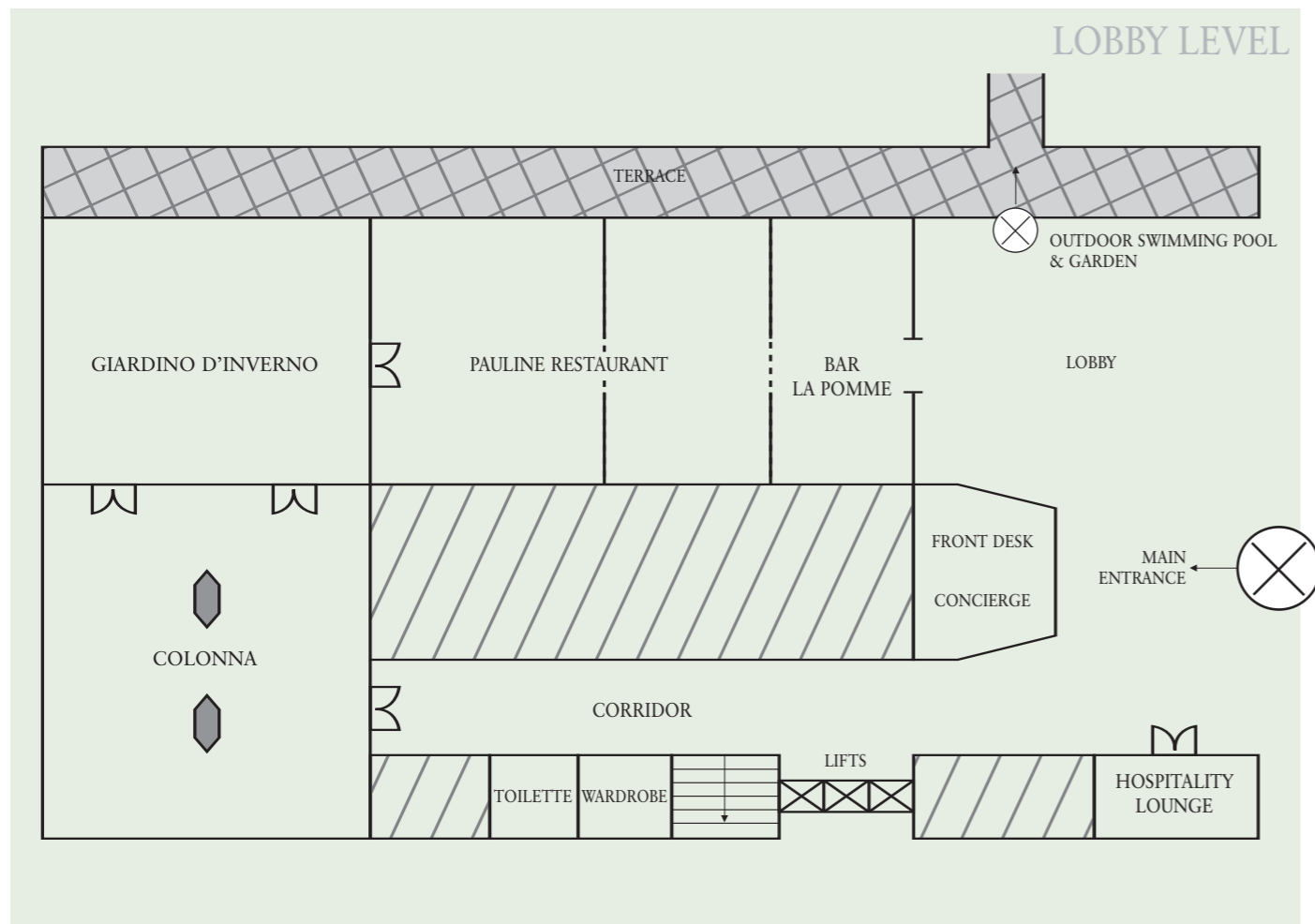

	Colonna	Giardino d'Inverno	Pauline Restaurant	Hospitality Lounge
<b>Rooms Dimension</b>				
meters	16,60x14,80	13,75x14,45	15,40x11,20	6,80x5,20
feet	54,70x48,80	45,30x47,60	50,80x36,90	22,31x17,06
square m.	246	199	172	35
square ft.	2.669,30	2.156,20	1.874,50	320
door dimensions m.	1,50x2,10	2,20x2,30	glass door	2,10x1,40
door dimensions ft.	4,92x6,88	12,50x8,20		6,88x4,59
ceiling height m.	3,50	3,10	3,24	•
ceiling height ft.	11,47	10,16	10,62	•
<b>Capacity</b>				
theatre style	•	•	•	30
class room style	•	•	•	24
“U” shape style	•	•	•	16
cocktail party	250	150	80	•
dinner round tables	190	100	60	•
buffet available	150	80	50	•

## MEETINGS & EVENTS

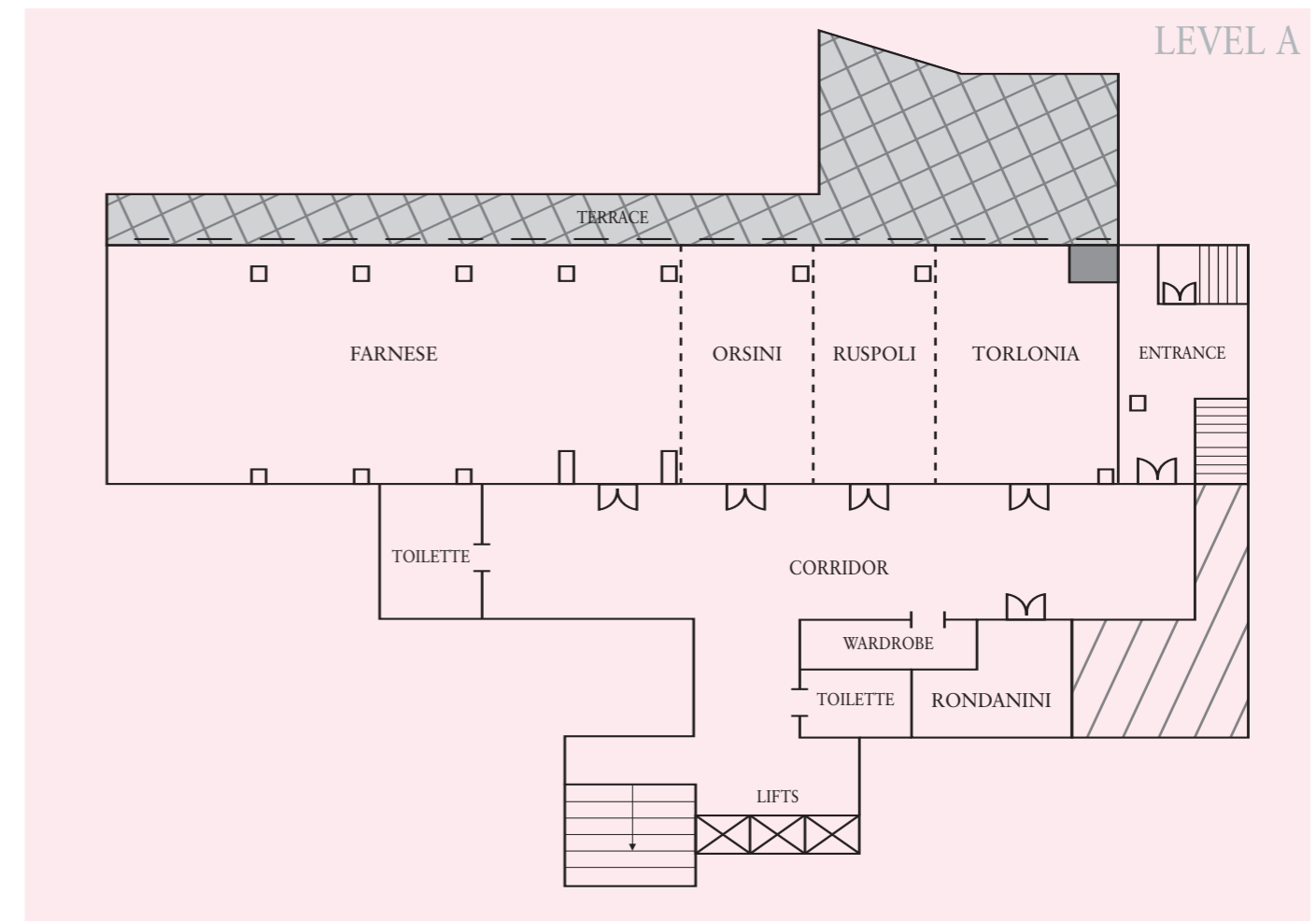

	Farnese	Orsini	Ruspoli	Torlonia	Rondanini
<b>Rooms Dimension</b>					
meters	37,60x12	7,20x12	7,20x12	9,60x12	4,30x7,70
feet	123x39,36	23,60x39,36	23,60x39,36	31,60x40	14,18x25,26
square m.	450	86	86	115	33
square ft.	4.842	929	929	1.264	356,40
door dimensions m.	2,38x1,99	2,38x1,99	2,38x1,99	2,38x1,99	2,10x0,90
door dimensions ft.	7,80x6,52	7,80x6,52	7,80x6,52	7,80x6,52	6,88x2,95
ceiling height m.	3,15	3,15	3,15	3,15	2,95
ceiling height ft.	10,30	10,30	10,30	10,30	9,67
<b>Capacity</b>					
theatre style	450	60	60	80	20
class room style	180	30	30	40	10
“U” shape style	80	25	25	35	14
cocktail party	400	60	60	80	•
dinner round tables	300	40	40	70	•
buffet available	250	40	40	60	•